

Scale: Horiz. 1" = 40'  
Vert. 1" = 4'

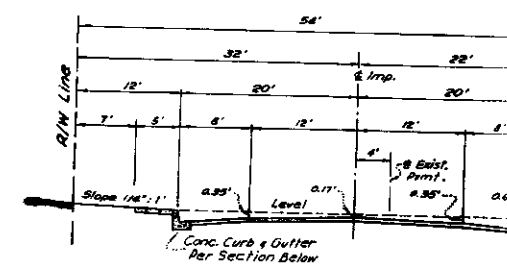
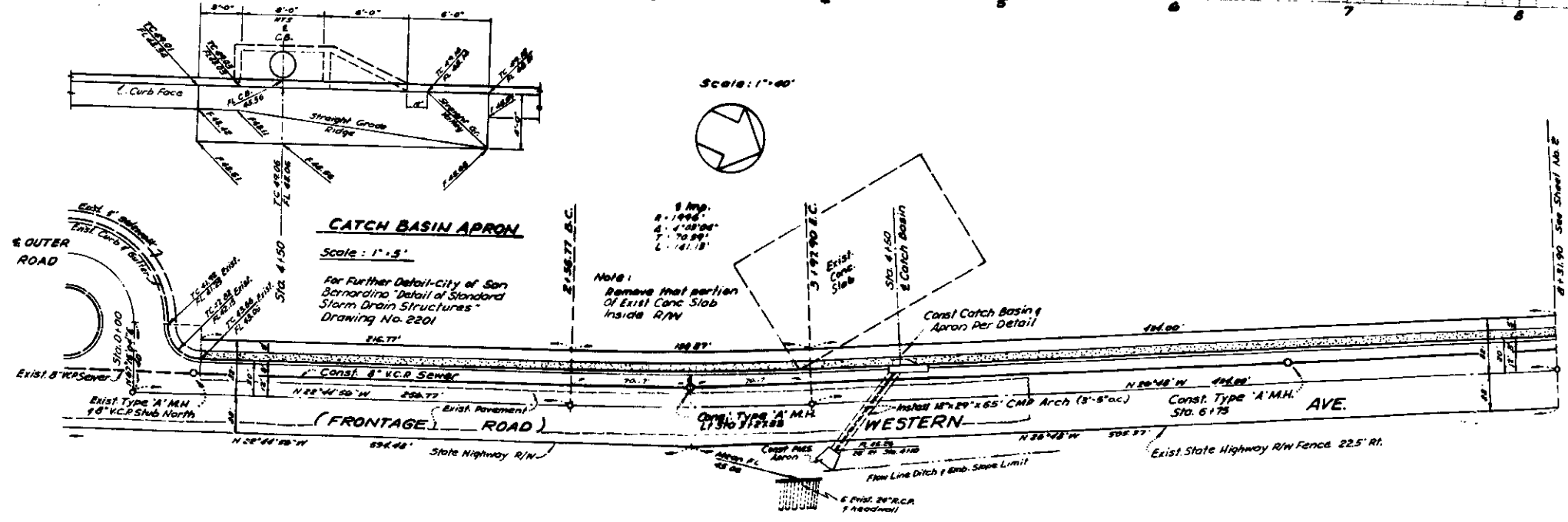

Typical Section  
WESTERN AVE.

NOTES:

- All work embodied on the plans shall be done in conformity with applicable provisions of Specifications No. 2271.
- All Standard Cross Sections of Curb, Gutter and Pavement are as per City of San Bernardino, Dept. of Engineering Std. Dwg. No. 23.
- Bench Mark: U.S.G.S. "7709" - About 4.0 MI. N. of A.T. & S.F. Rly. from Union Sta. about 0.45 MI. SE of Milepost 77, at Signal 772, in top of corner of conc. foundation and 7.3 ft. S.W. of west of S.W. rail of S.W. Track, Std. disk stamped "F 709 1943" Elev. 1305.37

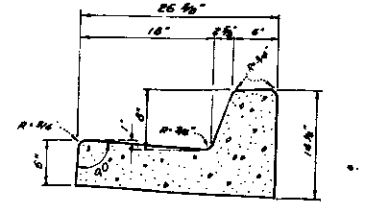
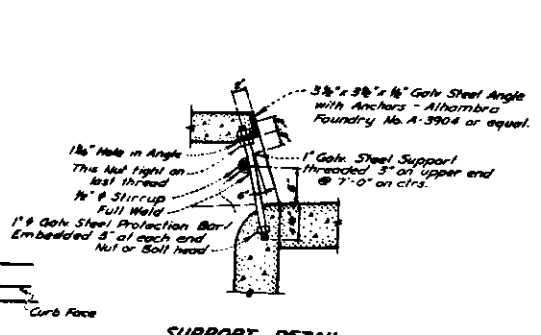
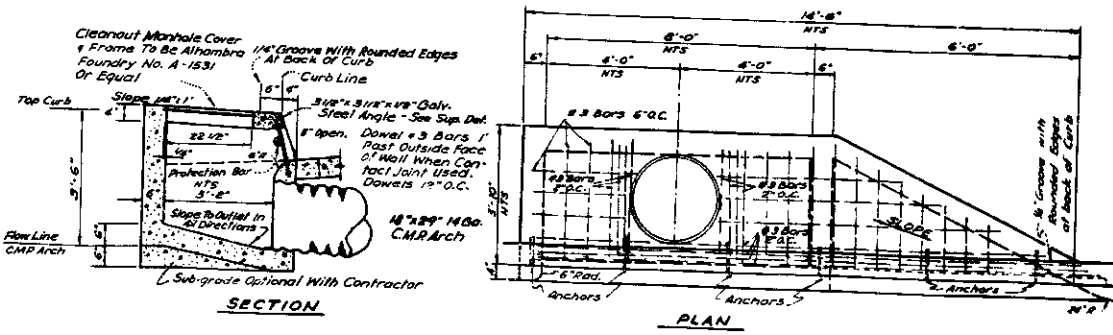

TYPICAL CURB SECTION

CATCH BASIN DETAIL  
Scale: 1" = 2'

For Further Detail See City of San Bernardino 'Detail of Standard Storm Drain Structures' Drawing No. 2201

<p>Chg. Catch Basin &amp; Added Steel No. 2</p> <p>NO. REVISION</p>	<p>R.E. Miller</p> <p>APPROVED</p>
<p>DEPARTMENT OF ENGINEERING</p> <p>CITY OF SAN BERNARDINO</p>	
<p>WESTERN AVENUE</p> <p>IMPROVEMENT PLANS</p>	
<p>SUBMITTED BY CAMPBELL &amp; MILLER REFERENCE</p>	

DATE 10-12-60